

[FIAT](#) / [PANDA](#) / [1.2 8V](#) / [PROCEDURES](#) / [21 GEARBOX UNIT](#) / [2127 ELECTRO-HYDRAULIC SELECTION. GEARBOX EXTERNAL CONTROLS](#)
 / [2127C HYDRAULIC GEAR SELECTION SYSTEM](#) / 2127C56 CLUTCH SOLENOID VALVE - R.R.

2752685 - 2127C56 CLUTCH SOLENOID VALVE - R.R.

 Removing ([Refitting](#) )

- [5530B10 battery - r+r](#)

- [5530B56 BATTERY DRIP TRAY COVER - R.R.](#)

- [5530B52 Battery DRIP TRAY/SUPPORT - R.R.](#)

- [2127C40 hydraulic speed selection hydraulic actuator unit and clutch - r r](#)

1. Disconnect the electrical connection (1a), undo the bolts (1b) and remove the clutch control solenoid.

	Name	Connector
1a	Clutch control solenoid	L56

2. Remove the O-ring.

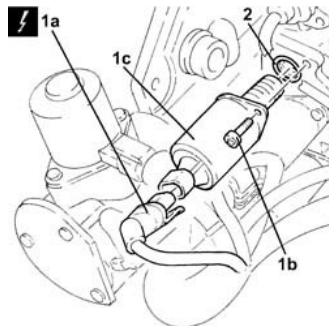

 Refitting ([Removing](#) )

Fit a new O-ring in the specific groove in the seating of the clutch control solenoid.

Fit the clutch control solenoid in its seating and tighten the fixing bolts.

Connect the electrical connection on the clutch control solenoid.

	Name	Connector
-	Clutch control solenoid	L56

- [2127C40 hydraulic speed selection hydraulic actuator unit and clutch - r r](#)
- [0010T21 coolant check density and top up if necessary](#)
- [0010T47 hydraulic system fluid for gearbox with hydraulic selection check level and top up if necessary](#)
- [0010T48 hydraulic system for gearbox with hydraulic selection bleed air](#)
- [5530B52 Battery DRIP TRAY/SUPPORT - R.R.](#)
- [5530B56 BATTERY DRIP TRAY COVER - R.R.](#)
- [5530B10 battery - r+r](#)

Connect the Examiner diagnostic instrument and initialise the gear engagement/selection positions, checking that the engagement travel is correct.